

Based on "6.44 ac."  
SE 11nd.

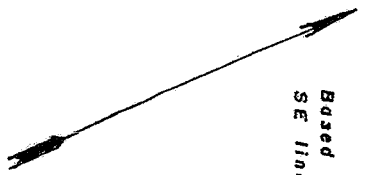

NOTE: Flood Hazard Boundary Maps  
are not available for this area.

Steven Bennett  
"12.16 ac."  
V. 1149 P. 338

(14)

LERROY  
BOULWARE

A-120

6.44 ACRES

MIKE LAND COMPANY

Millard Dixon "6.44 ac." V. 1140 P. 185

5177 P.R. 4052  
Normangee, Tx 77871

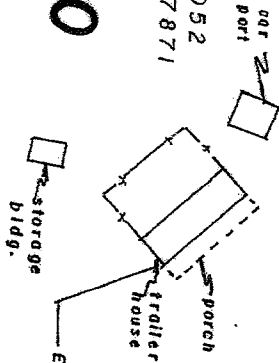

William Childers "10.06 ac." V. 1142 P. 399

(2)

James Ott "20.26 ac." V. 1141 P. 139

(1B)

LERROY  
BOULWARE  
A-121

L.R. Meador "4.50 ac." V. 1169 P. 820

(16)

1.02 AC.

Blaine Mircaile "5.07 ac." V. 1143 P. 419

(1A)

SURVEY PLAT OF 7.46 ACRES IN THE  
LERROY BOULWARE SURVEY, A-120  
LERROY BOULWARE SURVEY, A-121  
MIKE LAND COMPANY  
LEON COUNTY, TEXAS

SCALE: 1" = 100'

MAY 3, 2006

FREE & ASSOCIATES,  
CENTERVILLE, TEXAS 76833

P. O. BOX 317  
903-536-2564

David W. Free

R.P.L.S. No. 4010